

2012 Monclova Township Refuse Collection and Curbside Recycling Schedule

Refuse Limit: 6 Bags or 3 Cans or 1 Republic Services Toter - Curbside Recycling is Unlimited

JANUARY								FEBRUARY								MARCH								APRIL							
S	M	T	W	T	F	S	S	M	T	W	T	F	S	S	M	T	W	T	F	S	S	M	T	W	T	F	S				
*	1	H	3	4	S	6	NR	*			S	2	NR	4	*	4	5	6	N	8	SR	10	*	1	2	3	N	5	SR	7	
*	8	9	10	N	12	SR	14	*	5	6	7	N	9	SR	11	*	11	12	13	S	15	NR	17	*	8	9	10	S	12	NR	14
	15	16	17	S	19	NR	21		12	13	14	S	16	NR	18		18	19	20	N	22	SR	24		15	16	17	N	19	SR	21
	22	23	24	N	26	SR	28		19	20	21	N	23	SR	25		25	26	27	S	29	NR	31		22	23	24	S	26	NR	28
	29	30	31						26	27	28	S													29	30					

MAY								JUNE								JULY								AUGUST							
S	M	T	W	T	F	S	S	M	T	W	T	F	S	S	M	T	W	T	F	S	S	M	T	W	T	F	S				
*			1	N	3	SR	5	*					1	SR	*	1	2	3	H	S	6	NR	*			S	2	NR	4		
*	6	7	8	S	10	NR	12	*	3	4	5	S	7	NR	9	*	8	9	10	N	12	SR	14	*	5	6	7	N	9	SR	11
	13	14	15	N	17	SR	19		10	11	12	N	14	SR	16		15	16	17	S	19	NR	21		12	13	14	S	16	NR	18
	20	21	22	S	24	NR	26		17	18	19	S	21	NR	23		22	23	24	N	26	SR	28		19	20	21	N	23	SR	25
	27	H	29	30	N				24	25	26	N	28	SR	30		29	30	31						26	27	28	S	30	NR	

SEPTEMBER								OCTOBER								NOVEMBER								DECEMBER							
S	M	T	W	T	F	S	S	M	T	W	T	F	S	S	M	T	W	T	F	S	S	M	T	W	T	F	S				
						1	*		1	2	N	4	SR	6	*					1	SR	3	*						1		
*	2	H	4	5	N	7	SR	*	7	8	9	S	11	NR	13	*	4	5	6	S	8	NR	10	*	2	3	4	S	6	NR	8
*	9	10	11	S	13	NR	15		14	15	16	N	18	SR	20	*	11	12	13	N	15	SR	17	*	9	10	11	N	13	SR	15
	16	17	18	N	20	SR	22		21	22	23	S	25	NR	27		18	19	20	S	H	23	NR		16	17	18	S	20	NR	22
	23	24	25	S	27	NR	29		28	29	30	N					25	26	27	N	29	SR		23	24	H	26	N	28	SR	
	30																								30	31					

- * One Large Item Pickup on Scheduled Refuse Collection Day
- N Refuse Collection - North (Everything North of Monclova Road)
- S Refuse Collection - South (Monclova Road and Everything South)
- H Republic Services Holiday (Collections delayed one day)
- NR Recycling Collection - North (Everything North of Monclova Road)
- SR Recycling Collection - South (Monclova Road and Everything South)

FOR SERVICE RELATED ISSUES
CONTACT REPUBLIC SERVICES DIRECTLY

1-800-234-3429

Curbside Recycling is provided as a fee based service through Republic Services
Off week Refuse Collection is available as a fee based service through Republic Services

GARBAGE SERVICE COVERED UNDER MONCLOVA TOWNSHIP'S CONTRACT WITH REPUBLIC SERVICES:

- Normal household waste is collected every other week on a north or south route basis. The dividing line is Monclova Road (see map), with Monclova Road addresses being in the south route.
- Limit of 6 bags (approx. 30 gal.) or 3 cans (approx. 33 gal.) or one Republic Services toter (approx. 90 gal.). To assure compatibility with automated equipment on sanitation trucks toters must be purchased through Republic Services for \$48.75.
- Trash must be out by 7:00 AM. Garbage pickup could be any time after 7:00 AM on your collection day. Changes in weather conditions, crew assignment and equipment problems can create your pickup to be earlier or later in the day. Make sure it's always out by 7:00 AM.
- No metal or plastic barrels as trash receptacles.
- Pickup includes one large item on the first township pickup of the month; see asterisk on calendar; restrictions apply. Call Republic Services.
- No construction or remodeling debris; see below for details.
- No compost material or items prohibited by EPA or landfill regulations. Call Republic Services with questions; see below for details.
- No item will be accepted that will harm the sanitation worker or the truck; this includes excessive weight of container housing your garbage.
- Do not place loose garbage in your can or toter.

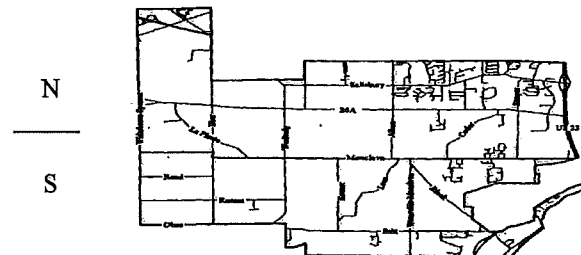

MISSED: The truck will not come back if you did not place your garbage out in time

QUESTIONS: Contact Republic Services at 1-800-234-3429.

DISPOSAL OF EXTRA GARBAGE: Residents may call Republic Services and purchase a book of tags, which will be mailed directly to you. Tags are to be attached to an extra bag /bags on township pickup days when there is garbage in excess of the six bag/three can/one toter limit. The tags are for bags ONLY. Tags are sold through Republic Services only.

DEFINITIONS:

LARGE ITEM: Examples-Stove, refrigerator with technician verification that Freon has been removed, washing machine, chair; Items with a weight so great that sanitation worker cannot move it to the lift will NOT be accepted. Items that could harm the truck or sanitation worker cannot be accepted (i.e. steel posts).

COMPOST MATERIAL: Yard waste (grass clippings, leaves, brush clippings, etc.) will not be accepted. Curbside and drop off fee-based programs are available. Call Ohio Compost, Monclova Township, 419-897-7807; Clean Wood Recycling, 6505 W. Bancroft or 6730 Anthony Wayne Trail, 419-843-9663; Republic Services, 1-800-234-3429 (seasonal service only) or contact your landscape company.

CONSTRUCTION DEBRIS: Building material resulting from remodeling, repair, demo operations or new construction